



BWM-070B

Instruction Manual



WASHING MACHINE

Before operating this product, please read these instructions carefully.

Congratulations on your purchase of the Binatone Washing Machine.

Binatone has an incredible heritage. Established 1958 in London.

We are an absolutely customer centric company! Words that are backed up with more than half a century of successfully delivering quality products to a customer base that spans more than 75 countries. Our commitment lies solely in delivering high quality yet affordable prices. Our teams, from engineering to manufacturing and marketing to sales, are all constantly pursuing an effort to make our products not just 'appliances' but 'lifestyle improvements'.

Binatone products are the product of European design and continuous development. During the initial design stages, engineers not only build in advanced features, ergonomics, and durability, but also international safety standards.

After the initial design stage, the product is then assembled from the most reliable components, in the most modern factories under the constant supervision of qualified Binatone Production and Quality Control Engineers. No compromises are made in the product's quality at any stage of the design or production process.

With Binatone's marketing network spanning across 75 countries the world over, large manufacturing volumes create economies of scale, which in turn allow us to offer our customers some of the world's highest performance and quality products at the best prices. This has long been the underlying philosophy, which has built Binatone into the leading international brand name today.

We recommend that before you buy any product, you first look at Binatone products. Critically compare their ergonomic designs, features, quality, aesthetics and of course their prices with any other brand. All Binatone product features are listed on their presentation boxes which makes it easier for you to make your purchase decision.

We wish you many happy years of use from the Binatone Washing Machine.

Content

Before using

Warning note1

Parts name.....3

How to use drainpipe 4

Water inlet hose installation5

Operation

Preparation before operation 6

Use of detergent7

Operation Step 8

Maintenance 10

Troubleshooting 11

Specification 12

Attachment 13

Attachment

Name	Quantity	Position
use manual	one piece	spin tub
gland	one piece	spin tub
water inlet hose	one piece	spin tub

Specification

Model	BWM-070B
Rated voltage and frequency	220-240V 50-60Hz
Water level(mm)/ water capacity(L)	Low water level: 163 Middle water level: 224 High water level: 285 Overflow water level: 326 Low water capacity: 27 Middle water capacity: 36 High water capacity: 43 Overflow water capacity: 49
Water Inlet pressure(MPa)	0.02MPa-0.2MPa
Rated washing capacity(kg)	7.0
Rated capacity of spin (kg)	5.0
Wash noise(dB)	≤ 62
Spin noise (dB)	≤ 72
Dimensions(mm)	721X408X819
Rated input power(W)	Wash : 350 Spin : 170

Warning Note

The product belongs to I class appliance and pls be careful to use.



Warning:
Safe use of
electricity



Warning Symbol: Once a product contains this sign attached, it involves the safety. So the product must be operated according to the requirement to avoid any damage on the machine or user.



Forbidden Symbol: This sign means forbidden behavior which will cause damage to the machine and users.

- Do not wash raincoat or car cover that are waterproof. If there are clothes that floats on the water surface, you should note the label on the clothes and confirm if it is okay to be washed by washing machine to avoid any break.
- Do not wash the clothes that contain the volatile substances such as gas.
- Waterproof clothing such as down jacket should not be put in the spin tub.



- Do not equip the machine in the bathroom where the place is humid and do not wash the machine.
- Do not put the machine on the place where it is hard to drain water.
- Do not put the wet clothing on the machine especially on the control panel.



- Do not alter the specifications or attempt to modify this product in any ways.
- Do not use the water hotter than 50
- Do not put the items on the washing machine.
- Keep the appliance away from the direct sunlight and heat sources like the heater.
- The distance between washing machine and wall is at least 5cm.

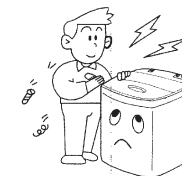

- This appliance is not intended for use by person (including children with reduced physical, sensory or mental capabilities, or lack of experience and knowledge, unless they have been given supervision or instruction concerning use of the appliance by a person responsible for their safety).
- Do not let the children climb the machine.
- Do not put the hand into the working machine. It is dangerous even if the speed is very slow.
- Do not let children play with the carton or any other packages.
- When the machine with glass top lid is open, the angle between top lid and horizontal plane is more than 60 degree then the lid can be released, avoiding any accident.

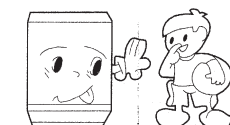

Warning Note

- The washing machine should not be situated on the windproof carpet. If so, please adjust the feet in order to allow air to circulate freely. Do not put the machine on the high platform to avoid falling down.

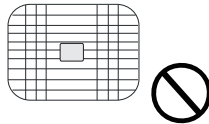

- Do not make the electric cable bended, stretched, twisted, strap-ped or changed, pressed or nipped.

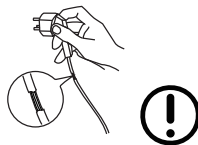

- If the electric cable or plug is damaged or the socket becomes loose, they must be repaired or changed by our appointed repair stations or the professionals of our post-sale service department to avoid danger.

- Always unplug the appliance and turn off the water when the power is cut, moving or cleaning the washing machine, or it is not in use.

- When the program is over, the tap must be closed and unplug the power to ensure the cut of washing machine. Have a check on the power cable and plug before next-time use.

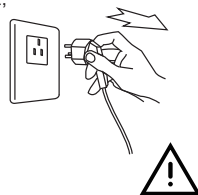

- Do not insert or pull off the plug with wet hand.

- Please insert the plug into the power socket with 220-240V single-phase three-stage AC.

- The plug must be the single special socket that meet national compulsory certification of qualified products.

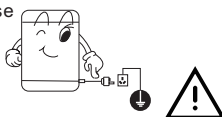

- The power must be connected with ground safely. The ground wire should be connected rightly and get away from underground water pipe and cable. If household electricity cannot reach the safety standard, it should be dealt with by professionals.



Troubleshooting

- When clothes fall out of the spin tub:

If the clothes fall out of the spin tub, please contact with our after-sale service, otherwise it will hinder draining.

- When the water remained freezes:

Pour water(below 50°C) into washing tub to have a full soak and then move the pulsator.

Drain water totally to avoid the frozen water. And make the Change-over switch to the "soft" or "standard". If the switch on the "drain", it is difficult to melt once the water freezes.

- Other troubles

If there are problems on the machine, pull out and check the plug first. After confirming the problem, contact with us. Do not repair it by yourself.

Phenomena		Reason	
The washing machine do not work	Power cut?	Plug is not inserted tightly?	Something impede pulsator?
It does not drain	Drainpipe is bended or get blocked?		
Noise during washing	Hard items put into the washing tub?		
Noise and strenuous vibration	The machine is balanced?	Too much laundries?	
	The clothes is put rightly?		
Some water in the drain hose and the machine	The remaining water when the factory make test which is a normal phenomenon		
Drop of water on the surface of tub	It is normal when environment temperature is higher than the normal water temperature.		

maintenance

Note: • Close the tap after washing and discharge the drain hose.

- Before cleaning, pull plug off .
- Hang up the power cord and drain hose.



Lint filter cleaning

- The use of filter is a must during the washing process and should be cleaned after it is used.
- Make sure the lint filter into a proper position to avoid the filter falling off.

Cleaning step

- ① Press two buckles to take out of the lint filter (see illustraion 1)

- ② Clean the filter (see illustraion2)

- ③ Install the lint filter (see illustration 3)

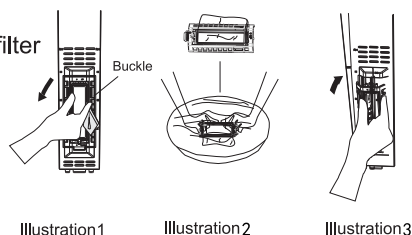

- Use neutral detergent when the machine is dirty. Do not use cleanser, volatile chemical materials to clean the machine, which will damage plastic parts and the surface.
- Do not spray towards the machine.
- Put the inlet hose down after working.
- Do not store water in the tub for a long time. Drain the water totally after using.
- Unplug it after using and hang the power cord in the right position.
- Clean the exterior cabinet of the appliance with soft cloth.

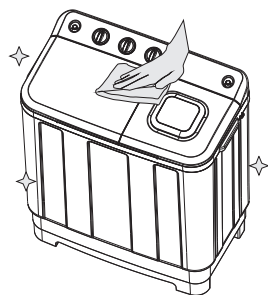

Parts Name

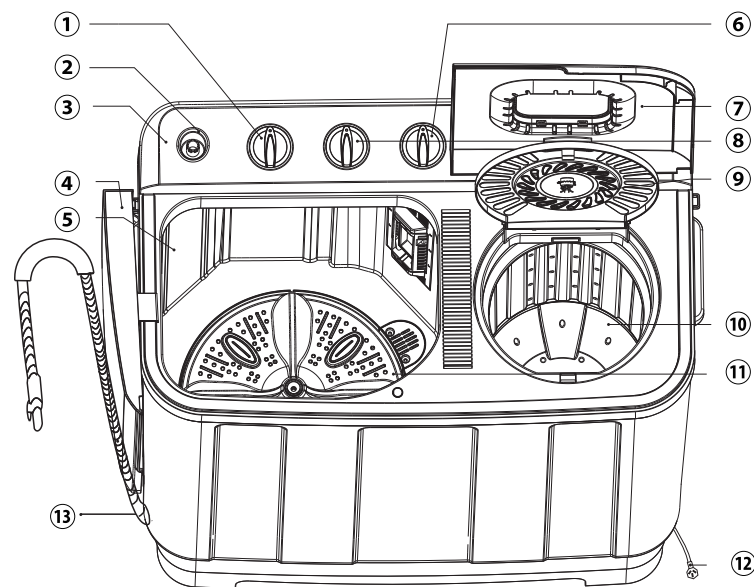

- | | |
|-------------------------------------|---------------------------|
| ① Wash timer | ⑧ Spin timer |
| ② Water inlet mouth | ⑨ Inner cover of spin tub |
| ③ Control panel | ⑩ Spin tub |
| ④ Cover for washing | ⑪ Pulsator |
| ⑤ Washing tub | ⑫ Power cord |
| ⑥ Change-over switch for water flow | ⑬ Drainpipe |
| ⑦ Cover for spinning | |

How to use drainpipe

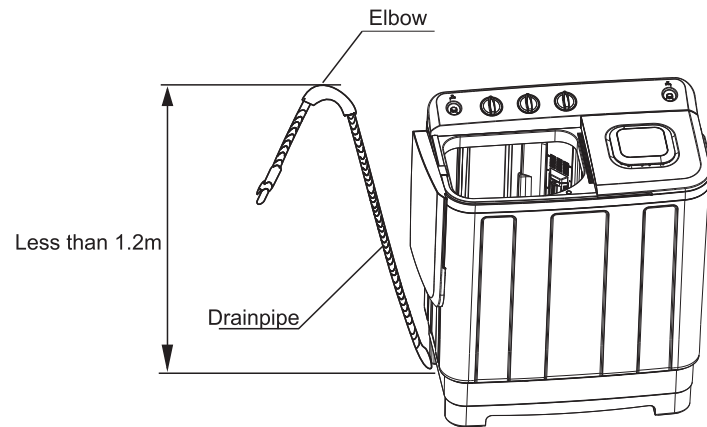

- 1.the drainpipe must be hanged during use, the height is not more than 1.2m to avoid leakage or stop, if drain a long time, the machine will stop running.
2. You can adjust the situation of the elbow bend pipe to change the height of the drainpipe.
3. Do not extrude the drainpipe to ensue drain smoothly.

Operation Step

(2) First spin process

1. Put the laundry into the spin tub smoothly.

2. Spin

- 1)Press the gland rightly
- 2)Close the spin top lid
- 3)Spin for 1-2 minutes

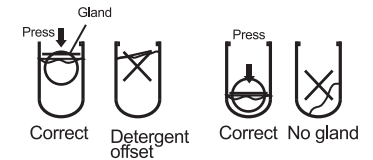

3.Spraying spin

- 1)Open the top lid of spin.
- 2)Put the inlet hose into the water inlet mouth and open the water tap. The water could spray and wash the laundry evenly to get rid of the foam.
- 3)Close the outer tub cover and spin for 1-2 minutes.

(3) Rinse Process

Put the laundry into the washing tub and select suitable water speed according to the laundry.

Stored rinse (repeated 2-3 times spin and rinse)

- 1.Fill the water to the suitable water level.
- 2.Time washer should be adjusted to 2-3 minutes to rinse. When the laundry is less ,select "soft"

(4) Second spin process

1.Put the laundry into the spin tub smoothly.

2.Put the gland rightly and close the spin tub cover.

3.Select the spin time according to the laundry. If there is noise during the spin, please replace the laundry smoothly.

- when the machine is spinning, if at the same time drain water,it should spin 1 min at first, and then to start drain water, otherwise it will stop as there are too much water in spin tub.
- when the machine is spinning, if open the spin tub cover, the machine will pause spin, close the cover of spin tub, the machine will go on spin.

Operation Step

1.Preparation before washing

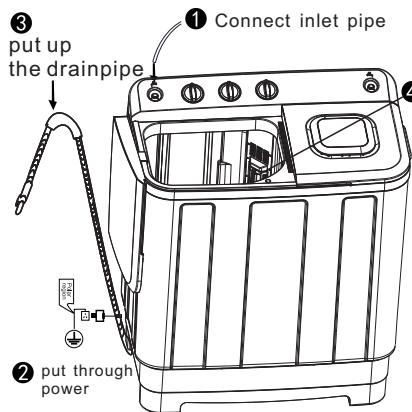

2.Washing Order

If the time should be set within 2 minutes, the timer should be set up more than 6 minutes first, then turn back to the 2 minutes.

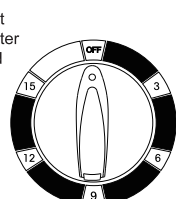

Wash timer

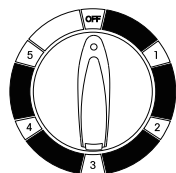

Spin timer

Change-over switch should be rotated forcibly.

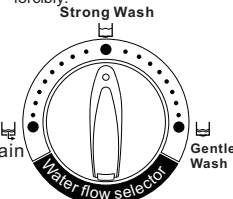

Change-over switch for water flow

If the time is required to be set within 1 minutes, the timer should be set up to 2 minutes first and then turn to the 1 minutes which could extend the life of timer.

(1) Wash process

- 1、 Fill water to the selected level. Add washing powder and then run for 30 seconds to dissolve it completely.
- 2、 Put laundries in and add water to the suitable water level.
- 3、 Select the water speed according to the laundry.
- 4、 Select the washing time according to the laundry.
- 5、 After washing,select the"drain".

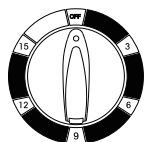

Wash timer

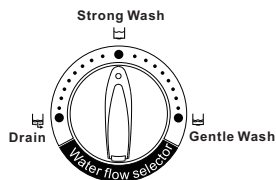

Change-over switch for water flow



Spin timer

Water inlet hose installation

Water inlet hose installation

Please install the hose according to the model.
Insert the water inlet hose into the water inlet mouth of control Panel(Refer to the right picture: control panel)

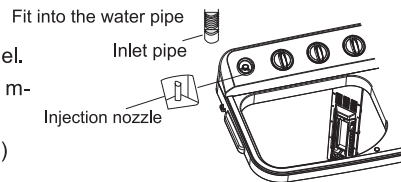

Water selector

Select water level according to the washing quantity.
(Choose water level: "high", "middle", "low")

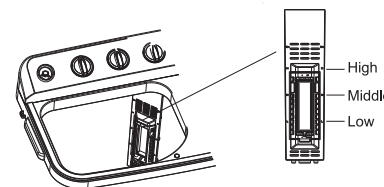

Lint Filter B Installation

Insert the bottom of the filter into the hole properly, then press the top of the filter to make it into the proper position.

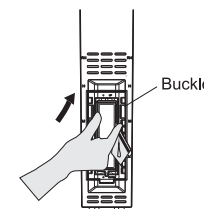

Preparation before operation

How to classify the laundry

- Make sure if there is any special requirements for the laundry.
- Before washing, empty all pockets of small objects which may have been left inside (coin, keys and etc.) As these could damage the drain pump.
- Knot the long band, fasten the buttons and close the zippers.
- Turn around the clothes with buttons to avoid any noise.
- Do not overload the machine. Load the laundry loosely.



Additional Notes:

- Make sure the laundries are washable.
- The broken clothes should be mended before being washed.
- Colored clothes should be washed separately from white ones.
- Please immerse the non-absorbable laundries by hand.
- Some stains such as fruit, wine, grass, rust etc. are difficult to remove and should be treated before washing with specific products, which can be found in most household shops. In some cases it may help to soak the stain before washing with a special pre-soak product or biological detergent.
- Overturn the nap fabric and long floss laundries before putting them into the machine.
- Do not put the laundries polluted by chemicals into the machine directly.
- Very small item (handkerchiefs, ribbons, socks etc) should be washed in a washing bag or a pillow case.

Use of detergent

How to use bleach

- Fill water to the selected level, dilute the bleach in the container, and pour it slowly into the washing tub.
- Do not use bleach for colored or figured laundries as they are prone to lose colors.
- Do not put bleach to laundries directly.
- Refer to the manual for the usage and quantity of the bleach.
- Please dissolve powder bleach before use.

How to use the washing powder

- Dissolve in the machine directly (not suitable for preset program)
 1. Low water level.
 2. Add the washing powder, and run for 30 seconds to dissolve it completely.
 3. Put laundries in, select suitable water level.
- The instant dissolving of the washing powder
 1. Prepare warm water of 30 in a container.
 2. Pour the powder while stirring to fully dissolve it.
- The washing powder is more prone to pollute the laundries than the detergent. therefore, please use it with proper dosage.
- The dosage of the washing powder, please refer to washing powder manual.
- It is suggested to use low foam washing powder.