

ENGLISH

# Binatone

Simply better

## DIGITAL VOLTAGE STABILIZER



To get the best results from your Binatone product  
please read these instructions carefully.

DVS-1001, DVS-1601, DVS-2001, DVS-3001, DVS-5001

**Binatone has an incredible heritage.**

**Established – 1958 in London, UK.**

We are an absolutely customer centric company!

With more than 60 years delivering quality products to our customers in more than 75 countries – our global footprint enables economies of scale.

This allows us to offer you some of the world's highest performance, quality & value products available in the market today.

Our commitment lies solely in delivering high quality, affordable products.

Our international team is constantly pursuing every effort to make products not just 'appliances' but 'lifestyle improvements'.

Check out all the latest Binatone products at:

[www.binatonelifestyle.com](http://www.binatonelifestyle.com)



# IMPORTANT SAFEGUARDS

When using electrical appliances – especially when children are present, basic safety precautions should always be followed to reduce the risk of fire, electric shock and/or injury to persons.

- ✓ READ ALL INSTRUCTIONS
- ✓ Make sure your power supply is consistent with the rated specification of the product before connecting.
- ✓ This appliance is not intended for use by persons (including children) with reduced physical, sensory or mental capabilities or lack of experience and knowledge – unless they are under supervision or instruction concerning use of the appliance by a person responsible for their safety. Children should be supervised to ensure that they do not play with the appliance.
- ✓ Do not operate any electrical appliance with a damaged cord or plug – or after the appliance malfunctions or has been dropped or damaged in any manner. Return the appliance to the nearest authorised service facility for examination, repair or adjustment.
- ✓ This product is intended for domestic indoor use only. Do not use outdoors or for commercial purposes .
- ✓ This product is not intended for use with traffic control systems, medical purposes, aviation/aerospace application or any kind of critical safety system.
- ✓ To protect against electric shock, do not place the product, cord or plug in water or other liquid.
- ✓ This product should not be used in the immediate vicinity of water, such as bathtub, washbowls, swimming pool etc. where the likelihood of immersion or splashing could occur.
- ✓ Unplug from the power outlet when not in use & before cleaning.
- ✓ Do not pull, twist or otherwise abuse the power cord.
- ✓ Use this appliance only for its intended use – as described in this manual.
- ✓ Do not connect any loads that will exceed its power output range – may lead to appliance damage, damage to the DVS unit, electric shock, or fire.
- ✓ Intended for installation in a controlled environment – do not place on an unstable cart, stand, or table.
- ✓ Do not place or operate the DVS in direct sunlight or close to other heat emitting sources.
- ✓ Do not place magnetic storage media on or near the DVS – this may result in data corruption.
- ✓ This appliance must be grounded (earthed)
- ✓ This appliance is single phase
- ✓ Keep away from source of vibration, corrosive gas, or fluids.

# KNOW YOUR APPLIANCE

Model No.	Specification	Front Panel	Rear Panel
DVS 1001	<p>Input: 110-280V~ 50Hz</p> <p>Output: 110 &amp; 230V~ 50Hz +/-10%</p> <p>Capacity: 1000W (1000VA MAX)</p>		
DVS 1601	<p>Input: 110-280V~ 50Hz</p> <p>Output: 110 &amp; 230V~ 50Hz +/-10%</p> <p>Capacity: 1600W (1600VA MAX)</p>		
DVS 2001	<p>Input: 110-280V~ 50Hz</p> <p>Output: 110 &amp; 230V~ 50Hz +/-10%</p> <p>Capacity: 2000W (2000VA MAX)</p>		
DVS 3001	<p>Input: 110-280V~ 50Hz</p> <p>Output: 110 &amp; 230V~ 50Hz +/-10%</p> <p>Capacity: 3000W (3000VA MAX)</p>		
DVS 5001	<p>Input: 110-280V~ 50Hz</p> <p>Output: 110 &amp; 230V~ 50Hz +/-10%</p> <p>Capacity: 5000W (5000VA MAX)</p>		

Operating Temperature: -10°C to 40°C

Operating Humidity: 0-90% RH (non-condensing)

## CONTROL PANEL



DISPLAY STATUS	NORMAL USE	SHORT DELAY (6s)	LONG DELAY (180s)
 INPUT VOLTAGE DISPLAY	Input Voltage (V)	Input Voltage (V)	Input Voltage (V)
 OUTPUT VOLTAGE DISPLAY	Output Voltage (V)	Count Down 006→001	Count Down 180→001
 LOAD CAPACITY DISPLAY	Load Capacity (%)	000	000
 DELAY INDICATOR	Off	Flash	Flash
 VOLTAGE PROTECT INDICATOR	Off	Off	Off
 OVERLOAD INDICATOR	Off	Off	Off

## BEFORE FIRST USE

Carefully remove all packaging and ensure the product is not damaged in any way. If you notice any damage – contact your authorized dealer or Binatone Customer Care (see Service & Customer Care)



**Do not try to operate the DVS in this situation!**  
**Do not try to repair the DVS by yourself!**

Follow the setup & operating instructions below.

## SETUP INSTRUCTIONS

1. The Digital Voltage Stabilizer (DVS) unit is heavy – when handling or moving it – use the carry handle(s) provided on the top.
2. Place the DVS onto a stable, level and flat surface.



Install the **DVS** in a cool, dry, clean place – away from windows, dust, moisture and cold. To prevent fire or electrical shock, do not expose this unit to rain or water.

3. Ensure there is at least 10cm gap between the DVS & any nearby articles.
4. Do not place anything on top of the DVS or allow anything to block the rear of the unit.
5. (**DVS-1001, DVS-1601 & DVS-2001**) Plug the DVS input power cord into a grounded (earthed) power outlet socket

(**DVS-3001 & DVS-5001**) Connect the input power wires from the DVS to a household wiring connection – ensure the ground (earth) is connected.

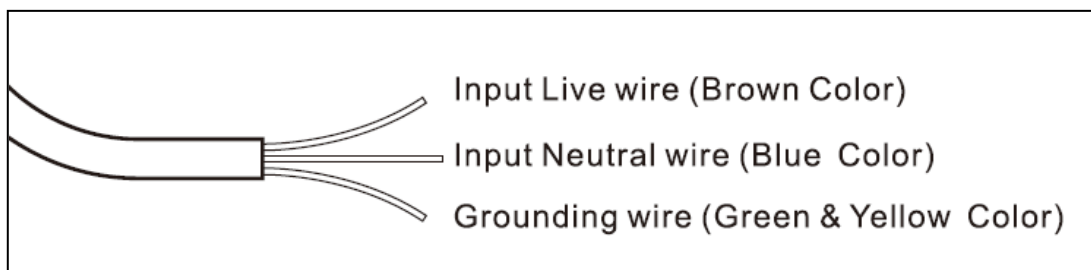

## POWER SUPPLY FROM GENERATOR

The DVS unit can be used with most generator sets as the incoming power supply – providing the following is met:



Special precautions:  
When the **DVS** input comes from a generator:

- a. Output power capacity must be higher than the **DVS** rating label, or the **DVS** and generator may not work properly;
- b. Output frequency of generator must be in range of 48Hz~52Hz or 58Hz~62Hz, and wave form must be sine wave, otherwise the **DVS** and generator may not work properly.

# OUTLET CONNECTIONS

On the rear panel of the DVS – socket outlets are provided – that can be used to plug in load appliances. Below are details of the socket outlets available on each model and the maximum loads possible.

## DVS-1001

MAX load is 1000W from all sockets (when input 230V~)

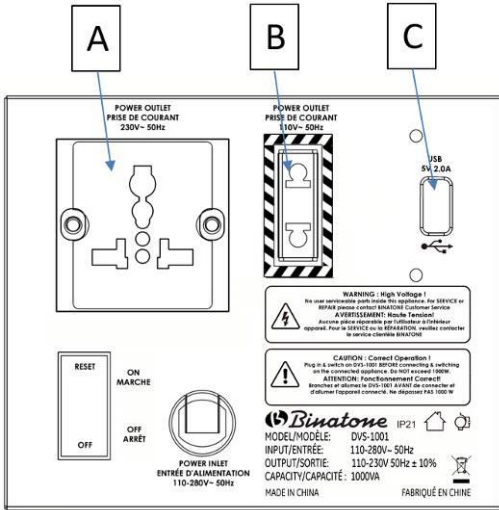

OUTLET CONNECTION	SOCKET TYPE	VOLTAGE & WATTAGE
<b>A</b>	Universal 3 pin socket	230V~ 50Hz 4.3A 1000W(*)
<b>B</b>	2 pin socket	110V~ 50Hz 3.18A 350W(*)
<b>C</b>	USB Type A	5V DC 2.0A (2000mA)

(\*) **CAUTION:** If more than one appliance is plugged into sockets A & B at the same time – the max combined wattage must not exceed **1000W**.  
Overloading the DVS will cause shutdown and  flashing on the display.

**CAUTION :** 2 pin socket for USA/JAPAN 110V~ appliances (outlet B), is clearly marked:  
This unit outputs 110V~ 50Hz – check your appliance can operate safely at 50Hz

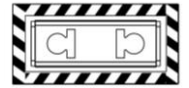

## DVS-1601

MAX load is 1600W from all sockets (when input 230V~)

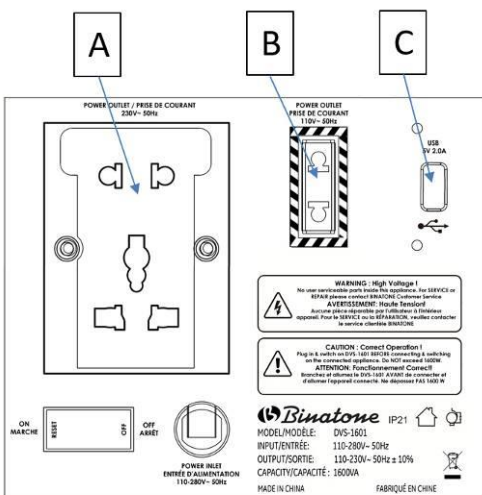

OUTLET CONNECTION	SOCKET TYPE	VOLTAGE & WATTAGE
<b>A (upper)</b> <b>A (lower)</b>	2 pin socket Universal 3 pin socket	230V~ 50Hz 8.69A 1600W(*)
<b>B</b>	2 pin socket	110V~ 50Hz 6.36A 560W(*)
<b>C</b>	USB Type A	5V DC 2.0A (2000mA)

(\*) **CAUTION:** If more than one appliance is plugged into sockets A & B at the same time – the max combined wattage must not exceed **1600W**.  
Overloading the DVS will cause shutdown and  flashing on the display.

**CAUTION :** 2 pin socket for USA/JAPAN 110V~ appliances (outlet B), is clearly marked:  
This unit outputs 110V~ 50Hz – check your appliance can operate safely at 50Hz





# OUTLET CONNECTIONS continued

## DVS-2001

MAX load is 2000W from all sockets (when input 230V~)

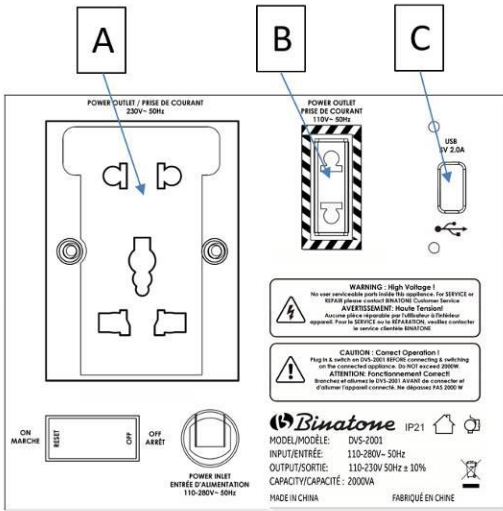

OUTLET CONNECTION	SOCKET TYPE	VOLTAGE & WATTAGE
<b>A (upper)</b> <b>A (lower)</b>	2 pin socket Universal 3 pin socket	230V~ 50Hz 8.69A 2000W(*)
<b>B</b>	2 pin socket	110V~ 50Hz 6.36A 700W(*)
<b>C</b>	USB Type A	5V DC 2.0A (2000mA)

(\*) **CAUTION:** If more than one appliance is plugged into sockets A & B at the same time – the max combined wattage must not exceed **2000W**.  
Overloading the DVS will cause shutdown and flashing on the display.

**CAUTION :** 2 pin socket for USA/JAPAN 110V~ appliances (outlet B), is clearly marked:  
This unit outputs 110V~ 50Hz – check your appliance can operate safely at 50Hz

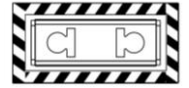

## DVS-3001

MAX load is 3000W from all sockets (when input 230V~)

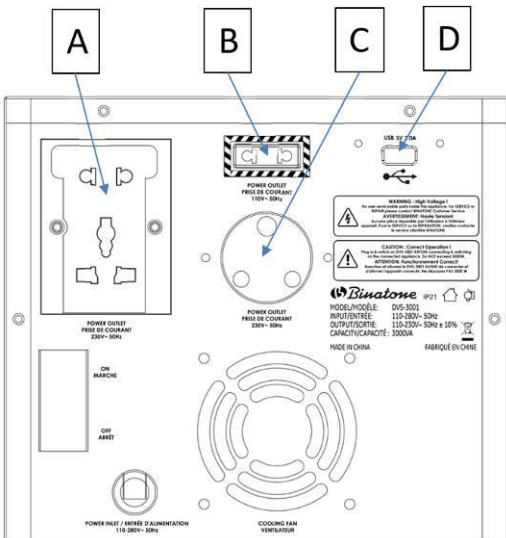

OUTLET CONNECTION	SOCKET TYPE	VOLTAGE & WATTAGE
<b>A (upper)</b> <b>A (lower)</b>	2 pin socket Universal 3 pin socket	230V~ 50Hz 13A 3000W(*)
<b>B</b>	2 pin socket	110V~ 50Hz 10A 1050W(*)
<b>C</b>	Type M - 3 pin socket For Air Conditioner	230V~ 50Hz 16A 3000W(*)
<b>D</b>	USB Type A	5V DC 2.0A (2000mA)

(\*) **CAUTION:** If more than one appliance is plugged into sockets A, B & C at the same time – the max combined wattage must not exceed **3000W**.  
Overloading the DVS will cause shutdown and flashing on the display.

**CAUTION :** 2 pin socket for USA/JAPAN 110V~ appliances (outlet B), is clearly marked:  
This uDnit outputs 110V~ 50Hz – check your appliance can operate safely at 50Hz

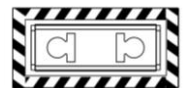





# OUTLET CONNECTIONS continued

## DVS-5001

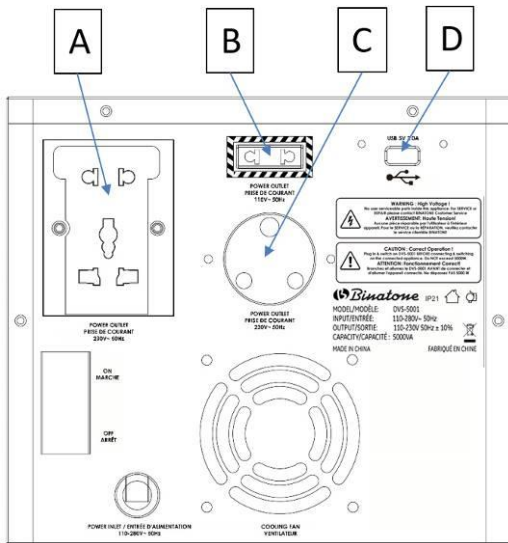
MAX load is 5000W from all sockets (when input 230V~)



OUTLET CONNECTION	SOCKET TYPE	VOLTAGE & WATTAGE
<b>A (upper)</b> <b>A (lower)</b>	2 pin socket Universal 3 pin socket	230V~ 50Hz 13A 3000W(*)
<b>B</b>	2 pin socket	110V~ 50Hz 10A 1100W(*)
<b>C</b>	Type M - 3 pin socket For Air Conditioner	230V~ 50Hz 16A 3680W(*)
<b>D</b>	USB Type A	5V DC 2.0A (2000mA)

(\*) **CAUTION:** If more than one appliance is plugged into sockets A, B & C at the same time – the max combined wattage must not exceed **5000W**.  
Overloading the DVS will cause shutdown and  flashing on the display.

**CAUTION :** 2 pin socket for USA/JAPAN 110V~ appliances (outlet B), is clearly marked:  
This unit outputs 110V~ 50Hz – check your appliance can operate safely at 50Hz

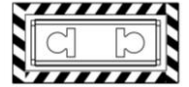

# OPERATING INSTRUCTIONS

1. Ensure the load appliance is switched OFF.  
Connect the load appliance to the appropriate outlet socket on the DVS (see Outlet Connections), ensuring the voltage is appropriate for the load appliance.  
**NOTE:** When connecting the load appliance - ensure the total load (wattage) of the connected appliance(s) does not exceed the rated maximum for the DVS.
2. Switch on the DVS unit – using the power switch (DVS-1001/DVS-1601/DVS-2001) or circuit breaker (DVS-3001/DVS-5001) - located on the rear panel.
3. The front panel will illuminate and indicate the input and output voltages
4. Depending on the position of the DELAY button – power output to socket A (DVS-1001/DVS-1601/DVS-2001) and sockets A & C (DVS-3001/DVS-5001) will start after the DELAY function is finished - either 6 seconds or 180 seconds (see DELAY FUNCTION for details)

**CAUTION :** 2 pin socket for USA/JAPAN 110V~ appliances (outlet B), as marked:  
This socket is not affected by the DELAY function. 110V~ is output as soon as unit is plugged into input power.

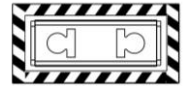

5. Switch on the load appliance  
**NOTE:** You can monitor the load on the DVS front panel – it will show the load capacity as a %age 888%
6. When usage is completed - switch off the load appliance and unplug from the DVS
7. Switch off the DVS unit – using the power switch (DVS-1001/DVS-1601/DVS-2001) or circuit breaker (DVS-3001/DVS-5001) - located on the rear panel.



The USB socket can be used to charge a wide range of mobile phones, tablets, mobile battery packs and similar devices.  
**NOTE :** The outlet is rated 5V 2A (2000mA) maximum. Some devices require a higher current but can still be charged from this USB outlet – though they may take longer to reach full capacity.

## In Case of Power Failure

Switch off the DVS unit – using the power switch (DVS-1001/DVS-1601/DVS-2001) or circuit breaker (DVS-3001/DVS-5001) - located on the rear panel.

When power is restored – follow the OPERATING INSTRUCTIONS steps 2 to 7 above.

# DVS SAFETY PROTECTION SYSTEMS

The Binatone range of DVS units come equipped with an Integrated Automatic Protection Circuit (IAPC) that monitors the appliance and provides these safety systems:

## OUTPUT OVER VOLTAGE PROTECTION

This system protects connected load appliances whenever the output voltage is higher than the normal range by cutting off the power & displaying  $V\uparrow$  on the Control Panel.

## OUTPUT UNDER VOLTAGE PROTECTION

This system protects connected load appliances whenever the output voltage is lower than the normal range by cutting off the power & displaying  $V\downarrow$  on the Control Panel.

## SHORT CIRCUIT PROTECTION

This system protects the DVS from short circuits & overload. Should such occurrence happen - the power switch (DVS-1001/DVS-1601/DVS-2001) or circuit breaker (DVS-3001/DVS-5001) on the rear of the DVS will trip.

BEFORE you reset the DVS, remove all load appliances & determine which has caused the short circuit protection to operate. Have the load appliance checked by a qualified service provider before reconnection to the DVS – to ensure no damage to DVS is caused.

## SMART OVERLOAD PROTECTION

This system protects the DVS from overload on the output sockets. The DVS can withstand some overload & continue working – for short periods (see table below) – before cutting off the power & displaying  $\text{⚡}$  on the Control Panel.

LOADING CAPACITY	DURATION
110 – 120%	30 seconds
>121%	6 seconds

It is recommended to remove unnecessary appliances from the output sockets when overload occurs.

## DELAY OPERATION

The DVS comes equipped with a dual mode delay feature – which is designed to protect connected load appliances that may otherwise be damaged by being switched on immediately after being switched off (such as may happen in a power cut or unstable low input voltage)



## DELAY OPERATION continued

### Short Delay - Mode 1 (button out)



When the input power is restored - this provides a 6 second delay before the output power is energised.

This is the default mode and can be used for all appliances not stated below.

### Long Delay - Mode 2 (button in)

When the input power is restored - this provides a 180 second (3 minutes) delay before the output power is energised.

This is specifically for appliances that contain pumps & compressors – such as fridges, fridge/freezers, chest freezers and air conditioners. It is designed to reduce damage due to frequent switching on/off.

During the DELAY function period – the Control Panel will display the time in seconds and countdown  and the DELAY ICON will flash 

## DVS OPERATION TIPS

Avoid overloading:

- Do not use the DVS beyond its maximum output power.
- When connected to any appliance with built in motor, pump or compressor – the starting power is generally several times that of the appliance's listed power rating.
- Make sure the total starting capacity of all connected appliances does not exceed the listed maximum power of your DVS.
- Make sure any connected appliance is of the same output voltage and frequency as the DVS outputs (see OUTLET CONNECTIONS)
- Make sure the input mains voltage is within the range as listed in the specification.
- Always place the DVS in an environment that is:
  - Well ventilated
  - Not exposed to direct sunshine or other heat source
  - Out of reach of children
  - Away from water, moisture, oil & grease
  - Away from flammable substances
  - Secure with no risk of falling



## CARE AND CLEANING

This appliance is basically maintenance free.

However, we recommend regular inspection to keep the unit functioning well.

Disconnect the DVS from the mains power & disconnect any load appliances.

Use a soft damp cloth and carefully wipe the front panel and body panels (taking extra care around the socket outlets at the rear).

Dry with a soft cloth or towel and ensure it is completely dry before re-use.

Do not use abrasive cleaners, harsh detergents, chemical cleaners or solvents as they may damage the surface finish of the product.

## SERVICE & CUSTOMER CARE

There are no user serviceable parts inside this appliance.



The DVS can only be repaired by the authorized technical service personnel. Any attempt to open and to repair by the user on his own could prove to be dangerous.

If the power cord or plug are damaged it must, for safety reasons, be replaced by Binatone or an authorised Binatone repairer.

If you need help with:

- using your product
- servicing or repairs (in or out of guarantee)
- spare parts

Please contact Binatone Customer Service at:



[www.binatonelifestyle.com/binatone/customer-service/](http://www.binatonelifestyle.com/binatone/customer-service/)



[www.facebook.com/BinatoneAfrica](https://www.facebook.com/BinatoneAfrica)

or search @BinatoneAfrica in Facebook or Messenger to find this page easily.

Have your model number & batch code ready – it is located on the rating label on your product

# WARRANTY

**Save your proof of purchase sales receipt.**



BINATONE warrants, subject to the conditions stated below, that from the date of purchase, this product will be free from mechanical defects for a period of two (2) years.

This is a domestic product – warranty does not cover products that have been used for commercial purposes.

BINATONE at its option, will repair or replace a product found to be defective during the warranty period. Should this product become defective by reason of improper workmanship or material defect during the specified warranty period, BINATONE will repair or replace the same effecting all necessary part replacements.

Transportation charges on parts, or products in whole, submitted for repair or replacement, under this warranty, must be borne by the purchaser.

CONDITIONS: This warranty is valid for the original retail purchaser from the date of initial retail purchase and is not transferable. Keep the original sales receipt. Proof of purchase is required to obtain warranty service or replacement. Dealers, service centres, or retail stores do not have the right to alter, modify or in any way, change the terms and conditions of this warranty.

Warranty registration is not necessary to obtain warranty on BINATONE products.

ABOUT YOUR PRODUCT WARRANTY: Most warranty repairs are handled routinely, but sometimes requests for warranty service may not be appropriate. For example, warranty service would NOT apply if the product damage occurred because of misuse, lack of routine maintenance, shipping, handling, warehousing or improper installation. Similarly, the warranty is void if the manufacturing date or the serial number on the product has been removed or the equipment has been altered or modified. During the warranty period, the authorized service dealer, at its option, will repair or replace any part that, upon examination, is found to be defective under normal use and service.

NORMAL WEAR & SERVICE/REPLACEABLE PARTS: This warranty does not cover normal wear of parts or damage resulting from any of the following: Negligent use or misuse of the product; Improper voltage or current; Use contrary to the operation instructions; Deviation from instructions regarding storage and transportation; Repair or alteration by anyone other than BINATONE or an authorized service centre; service parts replaced by user. Further, the warranty does not cover Acts of God, such as fire, flood, hurricanes, tornadoes etc.

Customers connecting BINATONE appliances directly to the mains power outlet or using a non-BINATONE stabilizer, risk voiding their BINATONE warranty. We recommend using quality BINATONE stabilizers for your protection – be wise, buy the best – always buy BINATONE

HOW TO OBTAIN WARRANTY SERVICE: Please contact BINATONE Customer Service (see Service & Customer Care section)





**Please consider recycling this  
instruction manual responsibly**

**Binatone Lifestyle Appliances**

**• LONDON • HONG KONG • DUBAI • LAGOS • ACCRA •**