

ENGLISH

 *Binatone*

Simply better

WATER DISPENSER

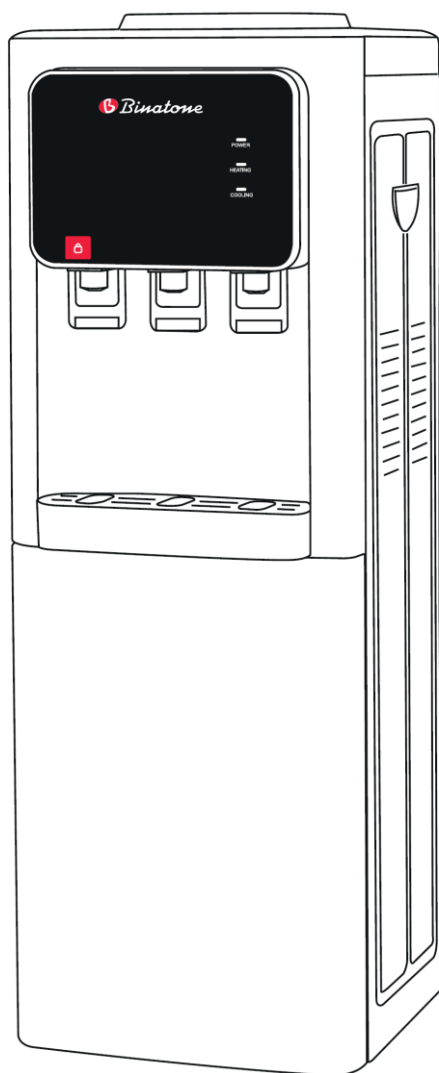

To get the best results from your Binatone product
please read these instructions carefully.

WTD-2020

Binatone has an incredible heritage.

Established – 1958 in London, UK.

We are an absolutely customer centric company!

With more than 60 years delivering quality products to our customers in more than 75 countries – our global footprint enables economies of scale.

This allows us to offer you some of the world's highest performance, quality & value products available in the market today.

Our commitment lies solely in delivering high quality, affordable products.

Our international team is constantly pursuing every effort to make products not just 'appliances' but 'lifestyle improvements'.

Check out all the latest Binatone products at:

www.binatonelifestyle.com



IMPORTANT SAFEGUARDS

When using electrical appliances – especially when children are present, basic safety precautions should always be followed to reduce the risk of fire, electric shock and/or injury to persons.

- ✓ READ ALL INSTRUCTIONS
- ✓ Make sure your power supply is consistent with the rated specification of the product before connecting.
- ✓ This appliance is not intended for use by persons (including children) with reduced physical, sensory or mental capabilities or lack of experience and knowledge – unless they are under supervision or instruction concerning use of the appliance by a person responsible for their safety. Children should be supervised to ensure that they do not play with the appliance.
- ✓ Do not operate any electrical appliance with a damaged cord or plug – or after the appliance malfunctions or has been dropped or damaged in any manner. Return the appliance to the nearest authorised service facility for examination, repair or adjustment.
- ✓ This product is intended for domestic indoor use only. Do not use outdoors or for commercial purposes.
- ✓ To protect against electric shock, do not place the product, cord or plug in water or other liquid.
- ✓ Unplug from the power outlet when not in use & before cleaning.
- ✓ Do not pull, twist or otherwise abuse the power cord.
- ✓ Use this appliance only for its intended use – as described in this manual.
- ✓ For optimum performance, operate at ambient temperatures between 16°C & 43°C
- ✓ Operate the water dispenser in a dry, cool, well ventilated area away from flammable and toxic materials.
- ✓ Do not damage the refrigerant condenser components – maintain at least 10cm clearance between the rear of the appliance and any surrounding objects.

SPECIFICATION

Rated Voltage	: 220-240v~	Hot Water Temperature	: ≤ 95° C
Rated Frequency	: 50-60Hz	Cold Water Temperature	: 6~10° C
Rated Power (Total)	: 590W	Hot Water Capacity	: 5L/H
Rated Power (Heating)	: 500W	Cold Water Capacity	: 1.5L/H
Rated Power (Cooling)	: 90W	Refrigerant	: R134a/45g
Rated Current (Cooling)	: 0.8A	Climate Class	: T
		Protection Class	: I

Circuit diagram

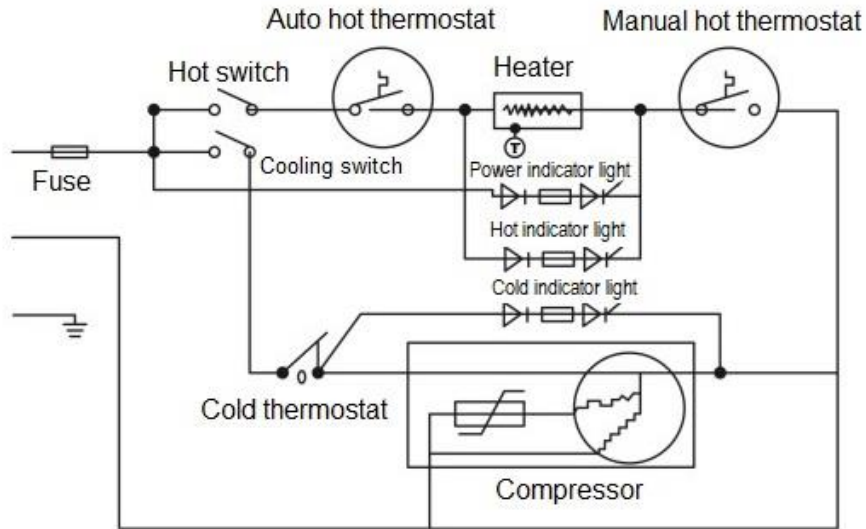

KNOW YOUR APPLIANCE

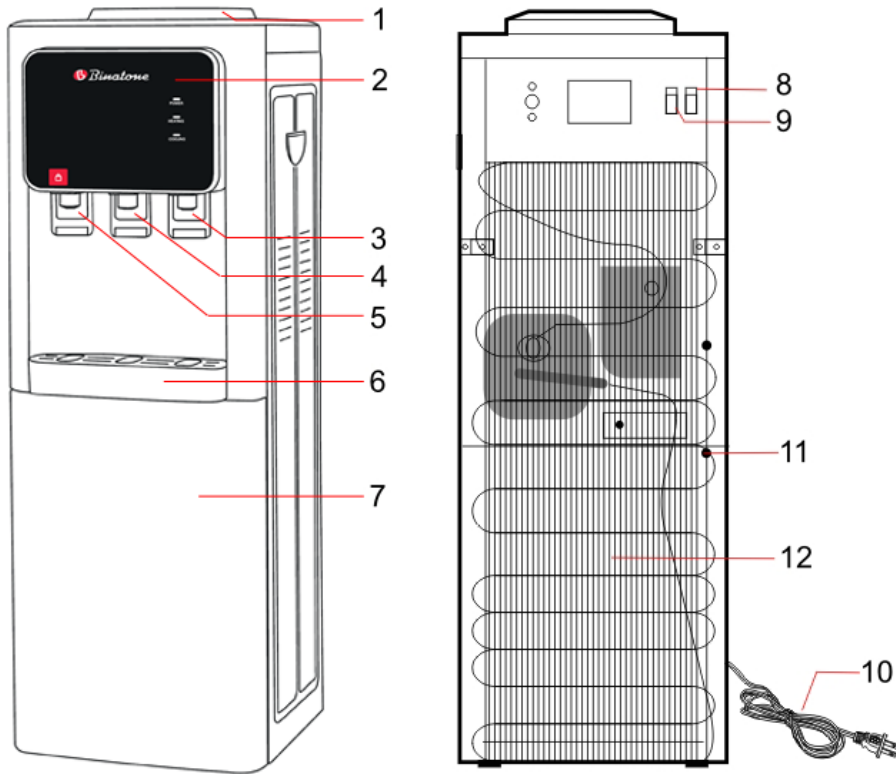

- 1) Upper Cover
- 2) Indicator Lights (*)
- 3) Cold water tap (blue)
- 4) Ambient water tap (white)
- 5) Hot water tap (red)
- 6) Drip tank & cover
- 7) 12L Fridge compartment
- 8) Heater On/off switch
- 9) Cooler On/off switch
- 10) Power cord & plug
- 11) Drain cover
- 12) Refrigerant condenser

(*) Indicator Lights

Power indicator (yellow)

Heating indicator (red)

Cooling indicator (green)

BEFORE FIRST USE

Carefully remove all packaging and assemble the product following the setup & operating instructions below.

The appliance should be used on a solid, level surface. It can be used free standing with care, ensuring at least 10cm clearance between the rear of the appliance and any surrounding objects.

Alternatively, the appliance can be secured using the supplied brackets – see Setup Instructions below for details.

Before connecting power & switching on – it is important to ensure the hot water system is filled with water and primed – to avoid damage to the heater.

We also recommend the appliance is flushed before 1st use

Follow these steps :

- 1) Ensure power cord (10) is unplugged and heater switch (8) set to off.
- 2) Install a water bottle to the appliance
- 3) Remove the dust prevention label on the lid
- 4) Open the red, hot water tap (5) until water starts to flow
- 5) Close the red, hot water tap (5)
- 6) Open the blue, cold water tap (3) until water starts to flow
- 7) Close the blue, cold water tap (3)
- 8) Open the white, ambient temperature tap (4) until water starts to flow
- 9) Close the white, ambient temperature tap (4)

SETUP INSTRUCTIONS

The appliance can be secured using the hardware provided.

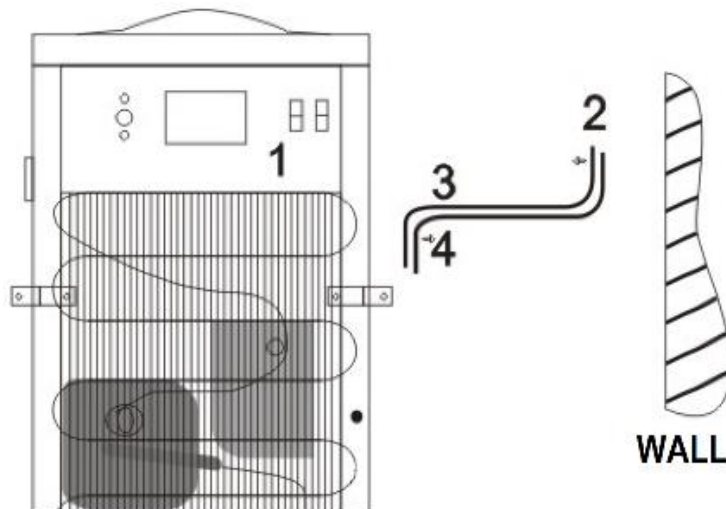

1) Water Dispenser

2) Wall fixing screw (2pcs)

3) S shaped bracket (2pcs)

4) Water dispenser fixing screw (2pcs)

SETUP INSTRUCTIONS continued

- 1) Secure the S bracket (3) to the rear of the water dispenser (1), using the supplied screws (4). There is one S bracket (3) for each side of the water dispenser (1).
- 2) Fit the S bracket (3), so that the end of the bracket near the wall, is to the left & right of the water dispenser (1) and is slightly wider than the water dispenser (1) housing. (see picture above)
- 3) Move the water dispenser (1) to the desired location and using the holes in the end of the S bracket (3) - mark the centres of the holes needed in the wall
- 4) Secure the water dispenser (1) using the supplied wall screws (2)

OPERATING INSTRUCTIONS

1. Hot water

Connect the power cord & plug (10) - the yellow power indicator light on the control panel will illuminate.

Switch the heater on/off button (8) at the rear of the appliance - the red power indicator light on the control panel will illuminate to show the heater is on.

Allow time for the water to be heated - until the red power indicator light goes off – the hot water is now up to temperature.



HOT WATER SAFETY – CHILD LOCK FEATURE

This appliance is fitted with a child safety feature – to dispense hot water, carefully open the red, hot water tap (5) AND press the red safety button at the same time. Water will not dispense if only one is operated at a time

Note: the red power indicator light on the control panel will go OFF when the water reaches approx. 90°C. As water is dispensed and ambient water is heated, the red power indicator light will come on again as the water temperature drops below approx. 75°C

2. Cold water

Connect the power cord & plug (10) - the yellow power indicator light on the control panel will illuminate.

Switch the cooler on/off button (9) at the rear of the appliance – the green power indicator light on the control panel will illuminate to show the cooler is on.

Allow time for the water to be cooled - until the green power indicator light goes off – the cold water is now down to temperature.

To dispense cold water, open the blue, cold water tap (3)

Note: the green power indicator light on the control panel will go OFF when the water reaches approx. 10°C. As water is dispensed, the green power indicator light will come on again as the water temperature begins cooling again.

OPERATING INSTRUCTIONS continued

3. Ambient temperature water

To dispense ambient temperature water, open the white tap (4).

It can be used with/without the power cord & plug connected (or during power outage)

4. Fridge Compartment

The fridge compartment (7) has a capacity of 12L and is ideal to cool canned/bottled beverages.

To use the fridge function, connect the power cord & plug (10) - the yellow power indicator light on the control panel will illuminate.

Switch the cooler on/off button (9) at the rear of the appliance – the green power indicator light on the control panel will illuminate to show the cooler is on.

Before using the fridge, allow at least 2 hours for the compartment to be cooled.

Enough space must be left between items stored in the fridge compartment to allow sufficient air circulation.

The fridge can maintain approx. 5°C but please note that it cannot make ice.

NOTE : If the cooling function is not in use (switch (9) is OFF), then the fridge compartment will also not cool. However, it can still be used as a storage area for non-perishable items. We do not recommend the fridge compartment is used for perishable items.

CARE AND CLEANING

This appliance requires little maintenance.

General Cleaning

We recommend dust is cleaned from the appliance body & refrigerant condenser (12) every few months, to keep it operating optimally. Cooling performance may deteriorate if the refrigerant condenser (12) becomes excessively dirty.

Before cleaning, unplug the power cord & plug (10) & empty the fridge compartment (7). If the unit is secured, it may be necessary to detach it from the wall to allow full access. Remember to re-attach it when cleaning is completed.

Wipe all parts carefully using a soft damp cloth, using warm water. Do not use hot water, detergents or abrasive cleaners/solvents.

CARE AND CLEANING continued

Water System Flush

Periodically, flush the water system with purified water – do NOT use any detergents, cleaners or solvents.

Unplug the power cord & plug (10), empty the fridge compartment (7) & remove any water bottle.

Open the top cover and carefully wipe down the water tray.

Open the drain cover (11) at the rear of the appliance and position a suitable vessel to catch any water.

Using purified water, pour it into the water inlet.

When all water has ceased flowing, close the drain cover (11) and replace the top cover

Drip Tray & Cover

Regularly remove and empty the drip tray & cover.

Wipe all parts carefully using a soft damp cloth, using warm water.

Do not use hot water, detergents or abrasive cleaners/solvents.

Descal Hot Water System

If you are using water bottles that are not distilled or demineralised water, then scale deposits can form in the heater system.

We recommend descaling the appliance every 6 months, or as needed.

Unplug the power cord & plug (10), empty the fridge compartment (7) & remove any water bottle.

Empty the water system by removing the drain cover (11) at the rear of the appliance and position a suitable vessel to catch any water. Replace the drain cover (11).

Remove the top cover.

Using a 5% citric acid solution in water – pour into the outlet.

Allow the citric acid to sit for 10 minutes, then remove the drain cover (11) at the rear of the appliance and position a suitable vessel to catch any water. Replace the drain cover (11).

Now flush the system thoroughly to remove all traces of the citric acid solution and scale deposits by following the instructions above for Water Flush System.

TROUBLE SHOOTING GUIDE

WARNING : Never switch on the heater switch (8) before placing the water bottle & allowing water flow into the appliance – otherwise the product maybe damaged.		
Problems	Possible Causes	Solutions
No water comes out of any tap(s)	Water bottle is empty Dust prevention label covering the inlet	Place/replace a full bottle of water Remove the dust prevention label
Hot & cold water is not available or not available at the right temperature	Excessive use of hot or cold water in a short period of time. Water dispenser not plugged into power outlet, or outlet is switched off Heater (8)/Cooler (9) switches not on	Retry 10 minutes later (allow time to heat/cool) Plug in power cord and ensure outlet switch is on Switch on heater(8) and cooler(9) switches at rear of appliance
Noise & vibration	Appliance is not level	Relocate the appliance to a flat, level surface
Water leak	Water bottle broken	Replace water bottle with a new one
No water flow from the cold water tap (3) (water bottle has water)	Ice block in system	Switch OFF cooler switch (9) and allow 4 hours to come to ambient temperature. Check flow & if OK, switch on cooler (9) If no flow - Contact your nearest Binatone service centre
No water flow from the hot water tap (5) (water bottle has water)	Thermal protector on heater has operated	Do not use the hot water system, ensure heater switch (8) is OFF Contact your nearest Binatone service centre
Noise from the water heater after prolonged use	Scale deposits may have formed in the heater – especially if using water that is not distilled/demineralised.	Follow the descale hot water system instructions above
Electrical earth leakage	The earthing circuit (grounding) of the electrical plug/outlet or home wiring system is poor.	This appliance is Class 1 and must be connected to a well maintained & reliable earthed (grounded) circuit. We recommend an earth leakage protector is used on the main circuit for your protection. Have your home wiring system checked by a qualified electrician.

SERVICE & CUSTOMER CARE

There are no user serviceable parts inside this appliance.

If the power cord or plug are damaged it must, for safety reasons, be replaced by Binatone or an authorised Binatone repairer.

If you need help with:

- using your product
- servicing or repairs (in or out of guarantee)

Please contact Binatone Customer Service at :

- www.binatonelifestyle.com/reach-us/customer-service.html
- Facebook - Binatonelifestyle

Have your model number ready – it's on the rating label on your product

WARRANTY

Binatone offers a 2-year warranty on this product.

If your product goes wrong within two years from the date you bought it, we will repair it (or replace it if necessary) free of charge provided:

- you have not misused, neglected or damaged it;
- it has not been modified (unless by Binatone);
- it is not second-hand;
- it has not been used commercially;
- you have not fitted a plug incorrectly; and
- you supply your receipt to show when you bought it.

This guarantee does not affect your statutory rights.



Please consider recycling this instruction manual responsibly

Binatone Lifestyle Appliances

• LONDON • HONG KONG • DUBAI • LAGOS • ACCRA •